

# WIND SURF

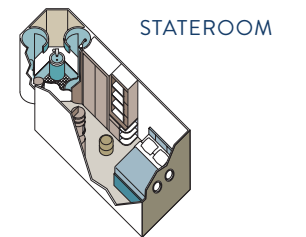
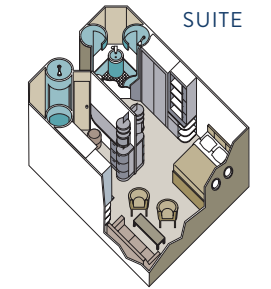
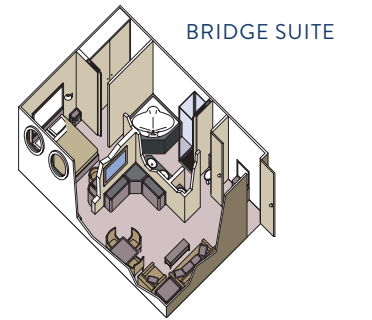
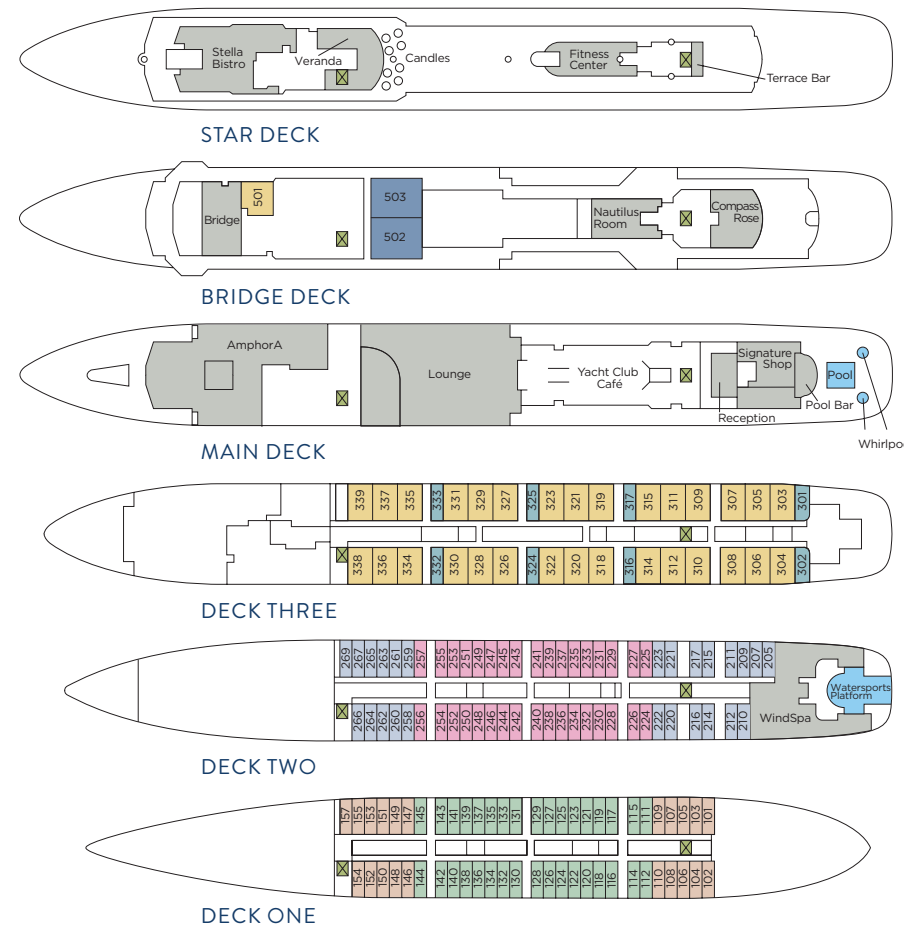

## ONBOARD SPACES

- |                         |                                 |
|-------------------------|---------------------------------|
| 1 Bridge                | 11 Compass Rose Bar             |
| 2 Stella Bistro         | 12 Reception                    |
| 3 AmphorA Restaurant    | 13 Nautilus Room                |
| 4 Bridge Suites         | 14 WindSpa                      |
| 5 Veranda               | 15 Signature Shop               |
| 6 Suites and Staterooms | 16 Pool / Pool Bar / Whirlpools |
| 7 Staterooms            | 17 Watersports Platform         |
| 8 Lounge                | 18 Terrace Bar                  |
| 9 Yacht Club Café       | 19 Candles                      |
| 10 Fitness Center       |                                 |

- BRIDGE SUITES
- SUITES
- CATEGORY TX DELUXE
- CATEGORY AX DELUXE
- CATEGORY A
- CATEGORY BX DELUXE
- CATEGORY B
- PUBLIC SPACES
- STAIRS/ELEVATOR



Illustrations are representative only. Actual layout of ships may vary slightly.

## SHIP FACTS

- GUEST CAPACITY:** 310
- GUEST DECKS:** 6
- CREW MEMBERS:** 200
- LENGTH:** 535 feet (162 meters) at waterline; 617 feet (187 meters) including bowsprit
- DRAFT:** 16.5 feet (5 meters)
- TONNAGE:** 14,745 gross registered tons (grt)
- BEAM:** 66 feet (20 meters)
- SAILS:** 7 triangular, self-furling, bridge-operated sails with 26,881 square feet (2,600 square meters) of Dacron surface area
- MASTS:** 5 at 221 feet (67.5 meters)
- ENGINES:** 4 diesel electric generator sets, 2 electrical propulsion motors
- SPEED:** 10 to 12 knots with engines only; up to 15 knots with prevailing wind
- SHIP'S REGISTRY:** Bahamas

## STATEROOMS & SUITES

- Bridge Suites:** 495 square feet (46 square meters)
- Suite 501:** 242 square feet (22.5 square meters), 1 bathroom
- Suites:** 376 square feet (35 square meters), 2 bathrooms

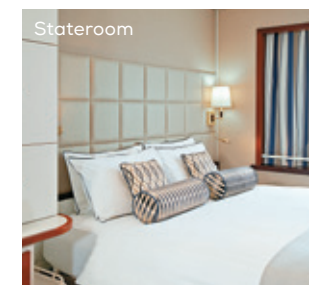

- Staterooms:** 188 square feet (18 square meters)
- Staterooms with 3<sup>rd</sup> Berths:** 117-140; all suites
- Staterooms with One Queen Size Bed Only (no twin option):** 101, 102, 157, 301-302
- Suites with One Queen Size Bed Only (no twin option):** 303 and 304

- Access to board ship is via stairs only.
- Access to/from outside deck may require assistance with doors and thresholds.